

InhibiCrobe™ GlassMat Antimicrobial Glass Cloth-Reinforced Wall System

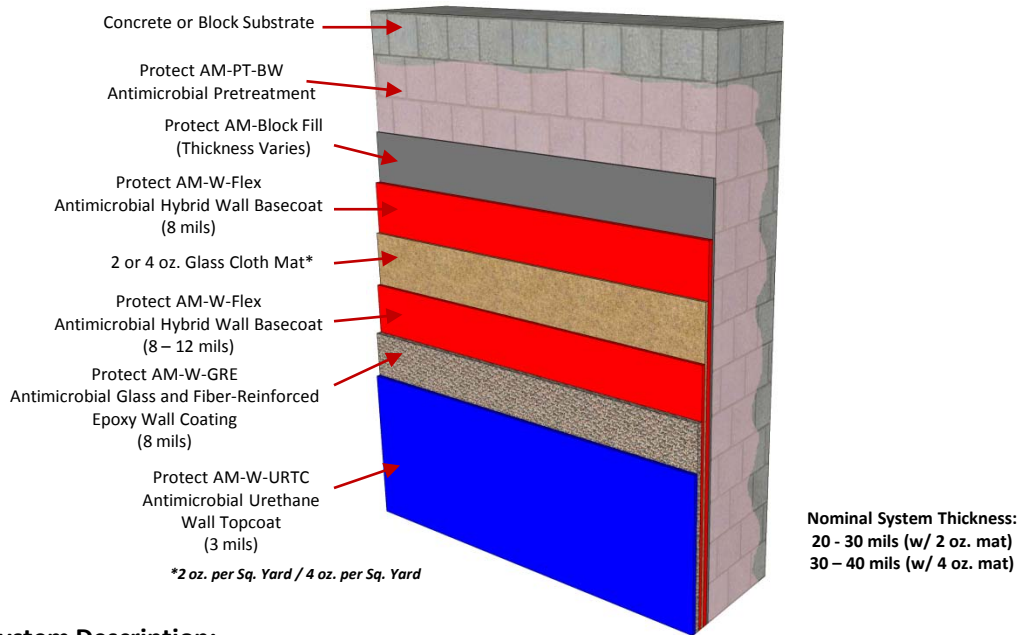

System Description:

A high-performance antimicrobial wall system consisting of an antimicrobial vertical-substrate concrete pretreatment, followed by an antimicrobial block-filler and an antimicrobial flexible hybrid basecoat reinforced with glass cloth mat. A 2nd application of the flexible hybrid basecoat is applied, followed by an application of an antimicrobial glass and fiber-reinforced epoxy build coat. This base is top coated with a high-performance antimicrobial urethane. This smooth, easy to wash system is formulated for use in areas where superior chemical resistance, durability and UV-stability are crucial.

System Advantages:

- Redundant system protects against microbe growth
- Antimicrobial protection penetrates up to 6" within concrete or block substrate
- Easy to clean and sanitize
- Superior durability
- Excellent chemical resistance and UV-stability
- USDA-compliant/CFIA-approved
- Quick turnaround minimizes downtime
- Antimicrobial properties effective for life of system

System Installation Overview:

1. Dampen concrete substrate prior to applying Protect AM-PT-BW
2. Spray-apply Protect AM-PT-BW in two passes and allow to fully purge concrete
3. Apply Protect AM-Block Fill and allow to cure
4. Apply Protect AM-W-Flex flexible hybrid wall basecoat and;
5. Place 2 or 4 oz. Glass Cloth Mat into wet basecoat and allow to cure
6. Apply 2nd coat of Protect AM-W-Flex and allow to cure
7. Apply Protect AM-W-GRE glass and fiber-reinforced epoxy wall coat and allow to cure
8. Apply Protect AM-W-URTC urethane topcoat and allow to cure